

PRINCESS 42

2012

300 000 EUR

800 engine hours

Finland, VAT is not paid

Maskim Ezhov
+7 921 412 83 58

EXTERIOR



MAIN CHARACTERISTICS

Length	13.48m
Beam	4.14 m
Draft	1.09 m
Displacement approx.	14 t
Hull color	White
Engine	Volvo Penta D6
Engine power	2 x 435hp
Fuel capacity	1362 l
Water capacity	455 l
Speed range	28-32 knots
Cabins	2+1
Berths	4+2

PRINCESS 42

2012

300 000 EUR

800 engine hours

Finland, VAT is not paid

Maskim Ezhov
+7 921 412 83 58

LAYOUT



Flybridge

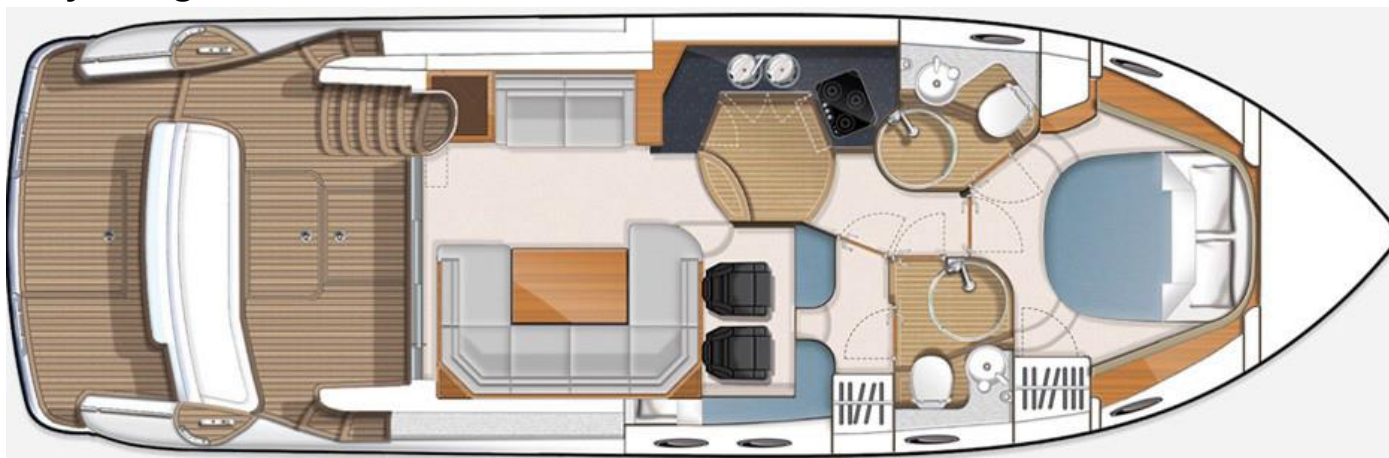

Main deck

PRINCESS 42

2012

300 000 EUR

800 engine hours

Finland, VAT is not paid

Maskim Ezhov
+7 921 412 83 58

SPECIFICATION

- Electro-hydraulic steering
- Bow thruster
- Electric system of direct current 24v and alternating current 220v
- Input for shore power supply 240v, adjustable device for charging batteries 50 A
- Remote control of an electric powered anchor winch from two control stations
- Trimmers with electric drive, indicators and controls at two control stations
- Autopilot on two control posts
- VHF radio with digital selective calling and intercom at two control posts
- Log with distance display on two control stations
- Sounder with alarm at two control stations
- Searchlight with remote control
- Microwave oven / conventional oven with grill
- Refrigerator with freezer
- A bar with a fridge
- A bar with a sink on flybridge
- Fridge on flybridge
- Toilets equipped with a silent flush with the electric drive
- TV LCD in salon
- Stereo CD player and radio in the cabin / flybridge
- Teak on the platform near the transom, cockpit deck, flybridge ramp and steps leading to the side
- Sunbed with pillows on the flybridge
- Three-section salon door with stainless steel frames
- The door in the transom
- Transom shower with hot and cold water

PRINCESS 42

2012

300 000 EUR

800 engine hours

Finland, VAT is not paid

Maskim Ezhov
+7 921 412 83 58

GALLERY



PRINCESS 42

2012

300 000 EUR

800 engine hours

Finland, VAT is not paid

Maskim Ezhov
+7 921 412 83 58

GALLERY

